



The CaRol Duratech 150 manual winch is designed to be installed in permanent installation (ex: wall mounting) or for temporary tasks, attached to Tracpode Pro\* using its console. The CaRol Duratech winch is primarily used for lifting materials in various industrial environments. The device is designed to be used in situations where the winch body is exposed to mildly corrosive environments, and where the wire rope may be in the contact with aggressive or corrosive substances.

\* Information about our Tracpode Pro and his console can be obtained upon request to Tractel or at [www.tractel.com](http://www.tractel.com).

## APPLICATIONS

- Chemical industry
- Sewage treatment plant
- Confined space
- Urban wastewater network
- Others

## TECHNICAL CHARACTERISTICS

- Compact, lightweight, and robust device
- W.L.L.\*\*: 150 kg
- Lifting height: 12 m
- Painted steel sheet frame and painted drum
- Stainless steel components:
  - Lifting wire rope
  - Swivel
  - Lifting hook
- Safety ratchet brake
- Use and mechanical parts protection through a protective cover
- Possibility to remove the crank to disable its use.
- Designed and built to withstand dynamic test at 1.1 x W.L.L.\*\* , static test at 1.5 x W.L.L.\*\* and to guarantee minimum mechanical resistance of 4 x W.L.L.\*\*
- Equipped with a QR code enabling product traceability monitoring

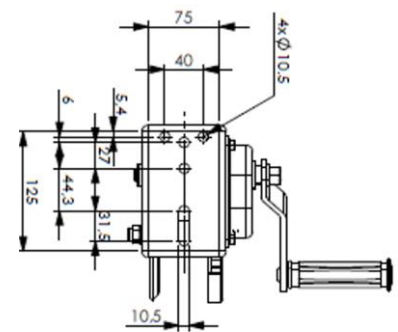
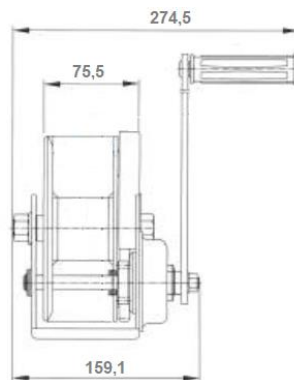
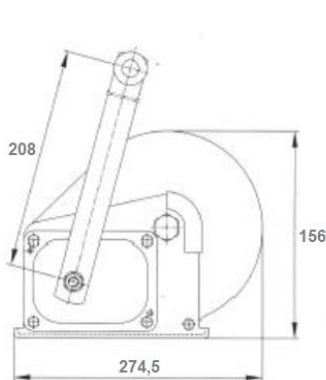

*The dimensions are expressed in mm.*

W.L.L.**(kg)	150
Lifting height (m)	12
Diameter wire rope (mm)	Ø 4.7
Lifting distance per crank turn (mm)	90
Force on crank (daN) <sup>(1)</sup>	17

\*\* : W.L.L. = Working Load Limit

<sup>(1)</sup>: At last winding layer



## APPLICABLES STANDARDS

- European directive 2006/42/EC
- UKCA Regulation  
Complies with all relevant provisions of the 2008 Supply of Machinery (Safety) Regulations (SI 2008/1597) as amended (SI 2011/1042, SI 2011/2157, SI 2019/696)

## PRODUCT CODE AND LOGISTIC INFORMATION

Code	Description	Code EAN	Net weight equipped (kg)	Weight (incl. packaging) (kg)	Packaging dimensions (mm)
218498	CaRol Duratech 150	3600232184980	5.3	5.8	160x160x220